

# IMPORTANT INFORMATION ABOUT ROADWORKS IN YOUR AREA

## UPDATED INFORMATION FOLLOWING PROGRAMME REVISION

### Works – A43. NORTHAMPTON TO KETTERING IMPROVEMENTS. PHASE 2

**Due for completion** – Spring 2018

**Progress to date** – Balfour Beatty has made good progress through the summer and achieved the key date to move the traffic onto the new carriageway permitting the commencement of the existing A43 carriageway construction.

The next phase is the opening of the new Park View junction and closure of the existing Park View access. This will allow the drainage and the external kerb line to the new roundabout to be completed ready for the November weekend closures when the surfacing will be completed to the finished profile.

Below Figure 1 depicts the current layout and Figure 2 portrays the new layout.

The decision to open the new Park View entrance during the day was to allow drivers the benefit of daylight to see and adapt for the new road layout.

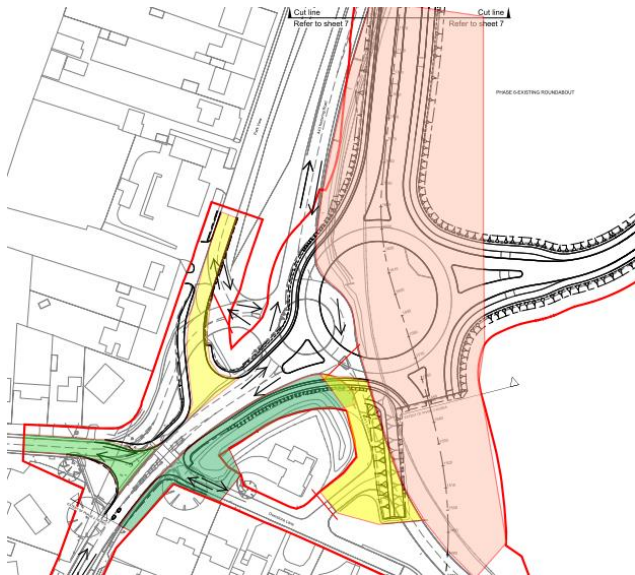

Figure 1 – Current Layout



Figure 2 – New layout in affect during 18/10/17

## IMPORTANT INFORMATION ABOUT ROADWORKS IN YOUR AREA UPDATED INFORMATION FOLLOWING PROGRAMME REVISION

What is the traffic management	Date	Times	What works are being carried out and alternative routes
<b>4 way lights.</b> A43 Moulton Roundabout.	16 <sup>th</sup> October to 18 <sup>th</sup> October	09.30 – 15.30	To facilitate the opening of Park View
<b>Weekend road closure in November.</b> A43 Kettering Rd From the junction with Ashley Lane/The Avenue to Sywell roundabout, and including Overstone Lane and Overstone Road	03/11/17 to 6/11/17  10/11/17 to 13/11/17	20.00hrs Friday through to 06.00hrs Monday	<p>Carriageway resurfacing</p> <p>A43 northbound through traffic alternative route at Round Spinney roundabout. Take the exit for the A5067 to the junction with A508 and turn right, follow the A508 to the A14, take the A14 eastbound to the junction for the A43, follow the A43 to Sywell roundabout. Alternative route for through traffic on the A43 southbound will be the reverse.</p> <p>Local traffic for Moulton or Overstone will use Ashley Road or The Avenue. There is a 7.5ton weight limit restriction on Ashley Lane which will need temporary suspension whilst this road is used as an alternative route.</p> <p>Additionally temporary parking restriction will be required on these roads.</p> <p>Provision will be made to allow access for residents on Park View during the times this road closure will be in place.</p>

**For more information on the background to the scheme, and further updates as published please go to [www.northamptonshire.gov.uk](http://www.northamptonshire.gov.uk)**

To ensure we deal with all enquiries and defect reports correctly please use our online Street Doctor service. This process ensures issues are recorded and dealt with quickly and appropriately. Once reported you will be issued with a unique reference number and will be able to follow the progress of your enquiry.

Website: [www.northamptonshire.gov.uk/streetdoctor](http://www.northamptonshire.gov.uk/streetdoctor)

Telephone: **0300 126 1000**

For information and transport and highway updates, follow us on **Twitter @nnhighways**

To view all roadworks and diversion routes in Northamptonshire go to [roadworks.org](http://roadworks.org)