

**KEY: SURFACE FINISHES**

- TARMACADAM SURFACE  
To access roads.
- TARMACADAM SURFACE  
To footpaths.
- BLOCK PAVIORS  
To parking bays.  
Marshalls 'Keyblok', colour - Brindle.
- CONCRETE SLABS  
To footpaths, etc.  
Marshalls 'Saxon', 400x400mm,  
colour- Natural
- PLANTING  
Planted areas.

**KEY: BOUNDARY FENCING**

- 1100mm high black painted  
(to match adjacent housing)  
20mm round top rail  
25x2 flat intermediate rails  
40x10 vertical members  
matching gates

**METAL RAILING DETAIL**

**TIMBER PICKET FENCING**  
"Timber Playtime" by Jacksons Fencing  
1100mm overall height  
95x35mm pales, with 75mm spacing  
95x35mm rails top and bottom  
145x35 gravel boards  
120x120 posts  
matching gates  
all finished in natural jackcure finish

**TIMBER CLOSE BOARDED FENCING**  
1800mm high timber close boarded fence panels  
145x35 gravel boards  
120x120 posts  
all finished in natural jackcure finish

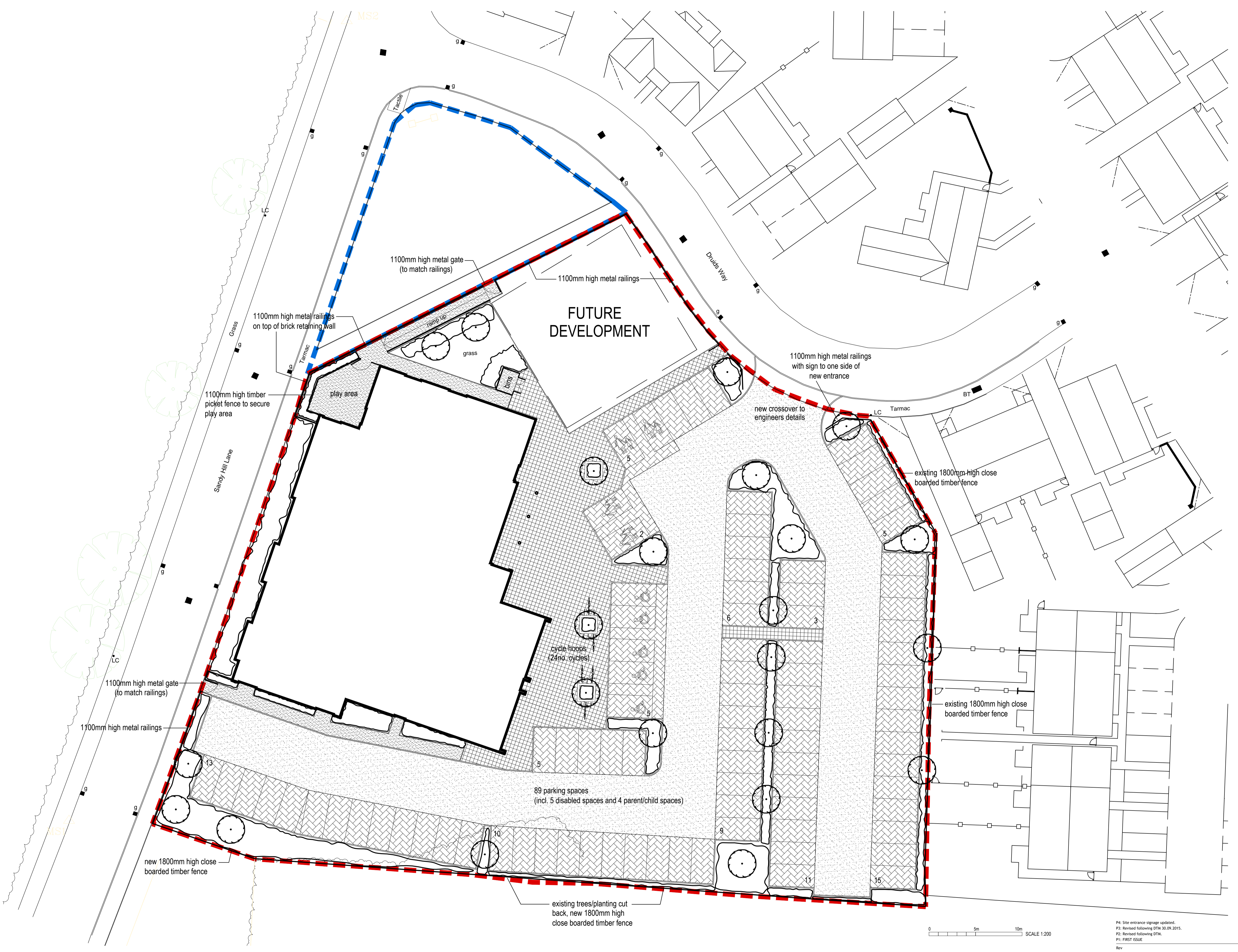

0 5m 10m SCALE 1:200

PH: Site entrance signage updated. 09.10.15 OB  
 P2: Revised following DTM. 03.10.15 PW  
 P3: Revised following DTM. 17.09.15 PW  
 P1: FIRST ISSUE. 13.08.15 OB

Rev: \_\_\_\_\_ Date/Checked: \_\_\_\_\_

The Old Rectory Rectory Lane Milton Malsor  
 NORTHAMPTON NN7 3AQ  
 t: +44 (0)1604 858916 f: +44 (0)1604 859123  
 www.peter-haddon.com

**php architects**

**COMMUNITY CENTRE AND LIBRARY  
 MOULTON PARISH COUNCIL  
 SANDY HILL LANE MOULTON**

Issue Purpose: **PLANNING**  
 Drawn by: OB Checked by: PW  
 Scale @ A1: 1:200 Date: AUGUST 2015  
 CAD ref: \_\_\_\_\_ Dwg no.: \_\_\_\_\_ Rev: \_\_\_\_\_  
**4181/201** **P4**

Copyright reserved. Dimensions to be checked on site. Discrepancies to be reported before proceeding.